

M 320F series

M 320F
P 311

☑ Copier ☑ Printer ☑ Facsimile ☑ Scanner



Simple & Robust for Every Budget

Make the best of your business with RICOH's new multifunction printer M 320F and single function printer P 311. This compact and robust devices can perform everyday tasks at affordable price.

Features for printers in this series include:

- Up to 32 pages per minute output
- Ultra-high yield 7,000 page. All-in-One (AIO) starter print cartridge included
- Supports Air print via mobile devices
- Best in class security — including SNMPv3-encrypted communications for device monitoring, secure email transmissions by SMTP over SSL/TLS
- Optional WiFi capability and 250-sheet tray
- Locked Print Support and @Remote Toner Auto delivery notification

Work From Home

Ricoh's new entry-level B&W devices, delivering all the advantages your customers need to work from anywhere with connectivity, mobility, complete control panel and simplified ease of use.

A compact, affordable package with reliable performance with an easy user-maintainable front access design to give you productivity without hassle.

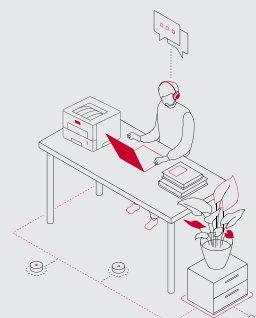

M 320F/ P311

MAIN SPECIFICATIONS

GENERAL

	M 320F	P 311
Warm-up time	30 seconds	26 seconds
First output speed: B/W	7.5 seconds	
Continuous output speed	32 ppm	
Memory: standard	256 MB	128 MB
Weight	18 kg	13 kg
Dimensions: W x D x H	405 x 392 x 420 mm	370 x 392 x 262 mm
Power source	220 - 240 V, 50 - 60 Hz	220 - 240 V, 50 - 60 Hz
Laser classification	Class 1 Laser Product (IEC60825 - 1:2014)	

COPIER

Multiple copying	Up to 99 copies
Resolution	1,200 x 600 dpi
Zoom	From 25% to 400% in 1% steps

PRINTER

Printer language: standard	PCL5e (MAC), PCL6 (Windows & Linux), PostScript3 (Windows)
Print resolution: maximum	1,200 x 1,200 dpi
Network interface: standard	Ethernet 10 base-T/100 base-TX USB2.0 Type B
Network interface: option	Wireless LAN (IEEE 802.11 a/b/g/n/ac)
Windows® environments	Windows® 8.1, Windows® 10, Windows® Server 2012, Windows® Server 2012R2, Windows® Server 2016
Mac OS environments	Macintosh OS X v10.10 or later
Other supported environments	Linux environment

SCANNER

Scanning: B/W	13 ipm
Scanning: full colour	4.5 ipm
Resolution: maximum	600 dpi

FAX

Compatibility	ITU-T (CCITT) G3
Transmission speed	3 seconds
Modem speed: maximum	33.6 Kbps

PAPER HANDLING

Recommended paper size	A4, A5, A6, B5, B6	
Paper input: standard	300 sheets	
Paper input: maximum	550 sheets	
Paper output: standard	50 sheets	125 sheets
Paper weight	52 - 162 g/m²	

ECOLOGY

Power consumption: operation	520 W	512 W
Power consumption: ready	69.4 W	63.8 W
Power consumption: sleep	0.868 W	0.725 W
TEC*	0.427 kWh/week	0.408 kWh/week

* It is a reference value based on the ENERGY STAR Ver.3.0 test method.

OUTPUT TRAYS AND FINISHER OPTIONS

1x 250-sheet paper tray

CONSUMABLES

Starter toner	7,000 prints
Toner (high yield)	7,000 prints

Consumable yield measuring method ISO/IEC 19798



Ricoh Latin America, Inc.

Please contact us for more information at:



www.ricoh-americalatina.com/en



Certified ISO9001
Certified ISO14001
Certified ISO27001

RICOH
imagine. change.

All brand and/or product names are trademarks of their respective owners. Specifications and external appearance are subject to change without notice. The color of the actual product may vary from the color shown in the brochure. The images in this brochure are not real photographs and slight differences in detail might appear. Copyright ©2021 Ricoh Latin America, Inc. All rights reserved. This brochure, its contents and/or layout may not be modified and/or adapted, copied in part or in whole and/or incorporated into other works without the prior written permission of Ricoh Latin America, Inc.