

# M 400FW

- ☑ Copier ☑ Printer
- ☑ Facsimile ☑ Scanner



## Productive, connectible, and secure

The reliable Ricoh multifunction printer M 400FW can provide all the capabilities your business needs to ensure maximum productivity without compromising the highest levels of security.

The M 400FW Features include:

### Compact yet productive

- Print speed up to 40 pages per minute (A4) letting the first page out within 6 seconds.
- Single pass scanning fast as 96 letter size images per minutes
- Fit in different space with the size of 339mm height x 411mm width x 366mm depth.

### Connectivity under high security

- Connect using Wi-Fi, Ethernet, USB and mobile such as Google Cloud Print, Mopria® and AirPrint technologies.
- Security architecture over different malicious attack keeping your document and information safe.
- Locked print feature available to keep your output safe using PIN code.

### Reliable quality with environmental friendliness

- High yield lasts up to 20,000 pages (ISO19752) with minimal downtime.
- Low annual energy consumption with power save mode helping to reduce environmental impact.
- Robust frame made of steel keeps long life usage and lifetime imaging components available to minimize maintenance.

## Work From Home and More

Ricoh's new mid-range B&W MFP device delivers all the advantages your customers need to work from anywhere. From the traditional corporate office requirements of productivity, reliability, and security; to the new hybrid and work-from-home styles, this solution also provides the connectivity, mobility, and easy-to-use needed in these emerging work environments.

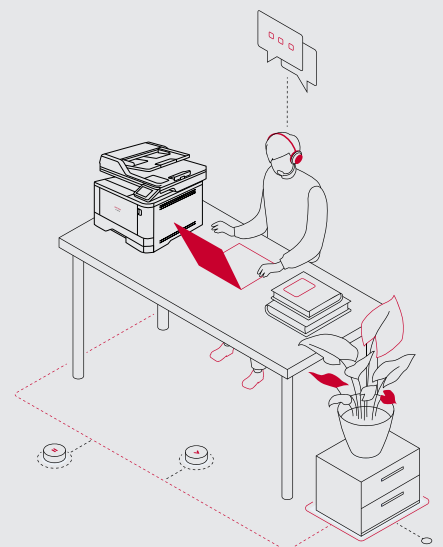

# M 400FW

## MAIN SPECIFICATIONS

### RICOH M 400FW

#### GENERAL

First output speed: B/W	5.9 seconds
Continuous output speed	40 ppm (A4)
Memory: standard	512 MB
Weight	12.8 kg
Dimensions: W x L x H	411 x 366 x 338 mm
Power source	100 to 127 VAC at 47 to 63 hertz (Hz) nominal or 220 to 240 VAC at 47 to 63 hertz (Hz)
Laser classification	Class 1 Laser Product

#### COPIER

Multiple copying	Yes (9,999 maximum number of copies)
Resolution	600 dpi horizontal; 300 or 600 dpi vertical
Zoom	25% to 400%

#### PRINTER

Printer language: standard (to be confirmed)	PCL5e (MAC), PCL6 (Windows & Linux), PostScript3 (Windows)
Printer resolution: maximum	2,400 x 600 dpi
Network interface: standard	Ethernet 10/100 Base TX (RJ-45) USB Compatible with USB 2.0 Specification (Type B)
Windows environments	Windows® 8.1, Windows® 10, Windows® Server 2012, Windows® Server 2012R2, Windows® Server 2016, Windows® Server 2019
Mac OS environments	Support is provided through Airprint and Airscan only
Other supported environments	Linux OS

#### SCANNER

Scanning: BW	Up to 46 IPM (A4 Simplex)
Scanning: full colour	Up to 20 IPM (A4 Simplex)
Resolution: maximum	600 x 600 dpi

#### FAX

Compatibility	ITU T.30
Transmission speed	< 3 seconds per page
Modem speed: maximum	33.6 Kbps

#### PAPER HANDLING

Recommended paper size	A6, Oficio, 7 3/4 Envelope, JIS-B5, A4, Legal, A5, Letter, Statement, Executive, Hagaki, Universal, DL Envelope, Folio, 9 Envelope, 10 Envelope, C5 Envelope, B5 Envelope, Monarch
Paper input: standard	350 sheets
Paper input: maximum	900 sheets
Paper output: standard	150 sheets
Paper weight	60 – 217g/m2

#### ECOLOGY

Power consumption	Current Average While Operating: 6.9 A (Low Volt) / 3.4 A (High Volt)
Power consumption: ready	7.5 W
Power consumption: sleep	1.1 W
TEC*	0.54 kWh/week

\* It is a reference value based on the ENERGY STAR Ver.3.0 test method.

#### OUTPUT TRAYS AND FINISHER OPTIONS

1x 550-sheet paper tray	Supported
-------------------------	-----------

#### CONSUMABLES

Starter toner	3,000 prints
Toner (high yield)	20,000 prints
Drum Unit	40,000 prints

Consumable yield measuring method ISO/IEC 19798 20,000 standard pages declared yield value in accordance with ISO/IEC 19752



### Ricoh Latin America, Inc.

Please contact us for more information at:



[www.ricoh-americalatina.com/en](http://www.ricoh-americalatina.com/en)



Certified ISO9001  
Certified ISO14001  
Certified ISO27001



All rights reserved ©2022. Ricoh Latin America, Inc. Ricoh and the Ricoh logo are registered trademarks of Ricoh Company, Ltd. All other trademarks are the property of their respective owners. The content of this document, and the appearance, features and specifications of Ricoh products and services are subject to change from time to time without notice. Products are shown with optional features. While care has been taken to ensure the accuracy of this information, Ricoh makes no representation or warranties about the accuracy, completeness or adequacy of the information contained herein, and shall not be liable for any errors or omissions in these materials. Actual results will vary depending upon use of the products and services, and the conditions and factors affecting performance. The only warranties for Ricoh products and services are as set forth in the express warranty statements accompanying them.